

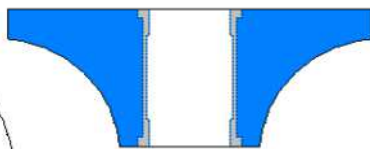

CNC Diamlox Polishing tools

Resin bonded diamond products

When you order, please indicate the model and :

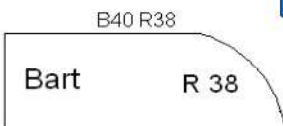
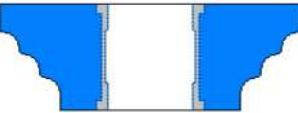
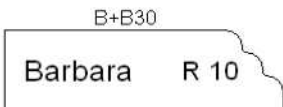
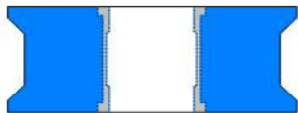
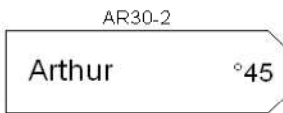
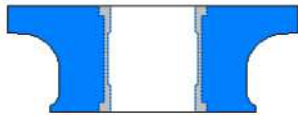
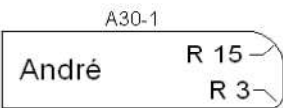
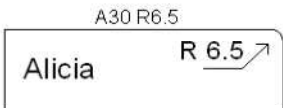
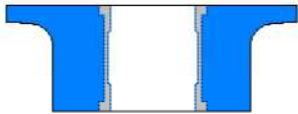
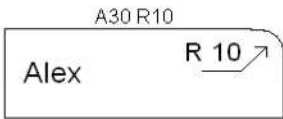
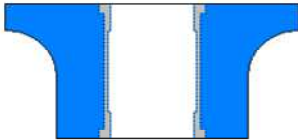
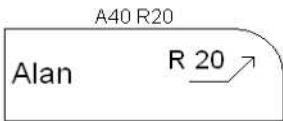
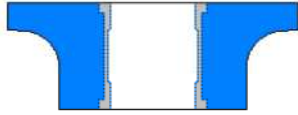
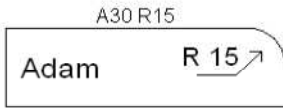

Diameter
 80mm (3 5/16"), 90mm (3 1/2")
 98,5mm (3 7/8"), 100mm (4")
 120mm (4 3/4"), 125mm (4 15/16")
 (Other diameters available)

For polishing stone of :
 2 cm (3/4"), 3 cm (1 1/4"), 4 cm (1 5/8")

Arbor hole
 22 mm (7/8"), 22,2 mm (7/8")
 35mm (1 3/8"), 45mm (1 3/4")

Code Ordering example :

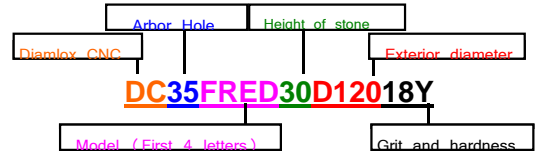

MADE IN CANADA



Suggested polishing parameters
 Speed : 1 m/min
 R.P.M. : 2500
 Compensation : 0,008 mm/m



CNC Diamlox Polishing tools

Resin bonded diamond products

When you order, please indicate the model and :

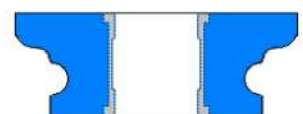
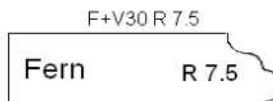
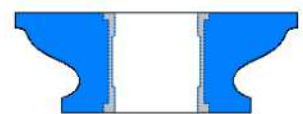
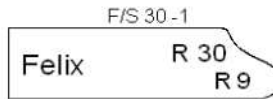
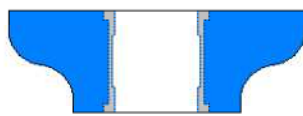
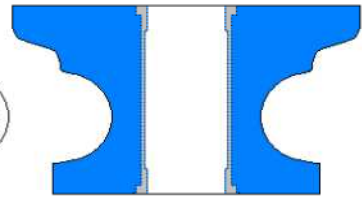
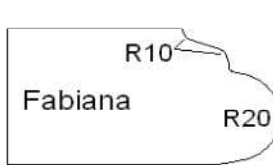
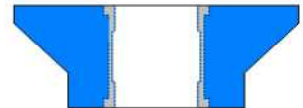
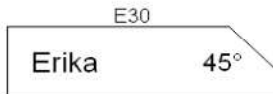
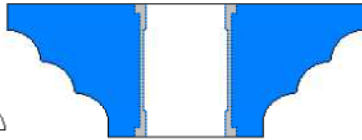
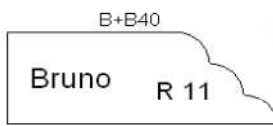
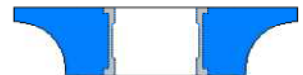
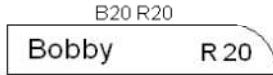
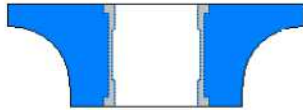
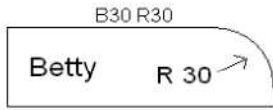

Diameter
 80mm (3 5/16"), 90mm (3 1/2")
 98,5mm (3 7/8"), 100mm (4")
 120mm (4 3/4"), 125mm (4 15/16")
 (Other diameters available)

For polishing stone of :
 2 cm (3/4"), 3 cm (1 1/4"), 4 cm (1 5/8")

Arbor hole
 22 mm (7/8"), 22,2 mm (7/8")
 35mm (1 3/8"), 45mm (1 3/4")

Code Ordering example :

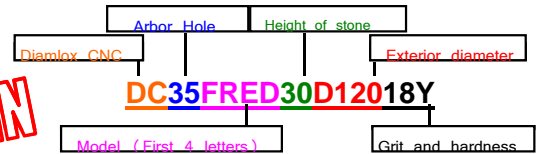

MADE IN CANADA



Suggested polishing parameters
 Speed : 1 m/min
 R.P.M. : 2500
 Compensation : 0,008 mm/m



CNC Diamlox Polishing tools

Resin bonded diamond products

When you order, please indicate the model and :

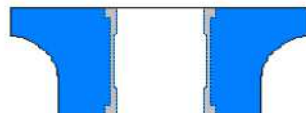
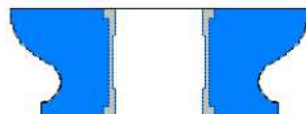
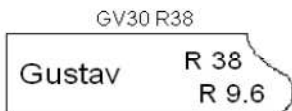
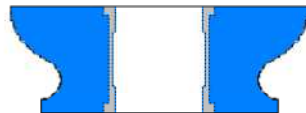
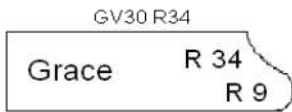
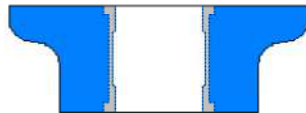
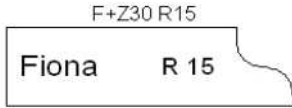

MADE IN CANADA

Diameter
 80mm (3 5/16"), 90mm (3 1/2")
 98,5mm (3 7/8"), 100mm (4")
 120mm (4 3/4"), 125mm (4 15/16")
 (Other diameters available)

For polishing stone of :
 2 cm (3/4"), 3 cm (1 1/4"), 4 cm (1 5/8")

Arbor hole
 22 mm (7/8"), 22,2 mm (7/8")
 35mm (1 3/8"), 45mm (1 3/4")

Code Ordering example :

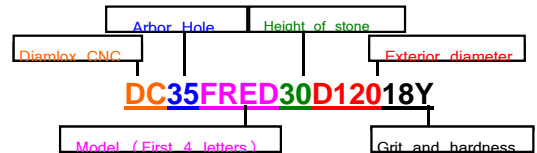

Suggested polishing parameters
 Speed : 1 m/min
 R.P.M. : 2500
 Compensation : 0,008 mm/m

CNC Diamlox Polishing tools

Resin bonded diamond products

When you order, please indicate the model and :

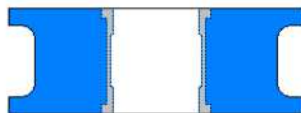
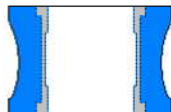
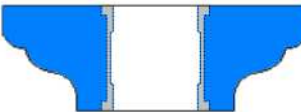
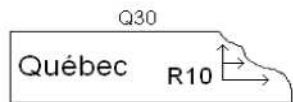
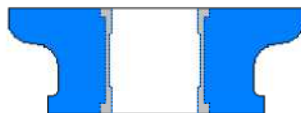
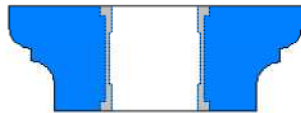
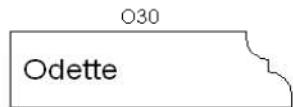
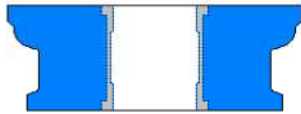
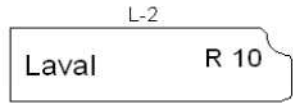

MADE IN CANADA

Diameter
 80mm (3 5/16"), 90mm (3 1/2")
 98,5mm (3 7/8"), 100mm (4")
 120mm (4 3/4"), 125mm (4 15/16")
 (Other diameters available)

For polishing stone of :
 2 cm (3/4"), 3 cm (1 1/4"), 4 cm (1 5/8")

Arbor hole
 22 mm (7/8"), 22,2 mm (7/8")
 35mm (1 3/8"), 45mm (1 3/4")

Code Ordering example :

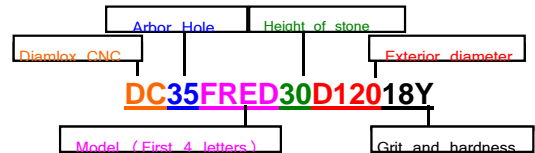

Suggested polishing parameters
 Speed : 1 m/min
 R.P.M. : 2500
 Compensation : 0,008 mm/m



CNC Diamlox Polishing tools

Resin bonded diamond products

When you order, please indicate the model and :

Diameter

80mm (3 5/16"), 90mm (3 1/2")
 98,5mm (3 7/8"), 100mm (4")
 120mm (4 3/4"), 125mm (4 15/16")
 (Other diameters available)

For polishing stone of :

2 cm (3/4"), 3 cm (1 1/4"), 4 cm (1 5/8")

Arbor hole

22 mm (7/8"), 22,2 mm (7/8")
 35mm (1 3/8"), 45mm (1 3/4")

Code Ordering example :

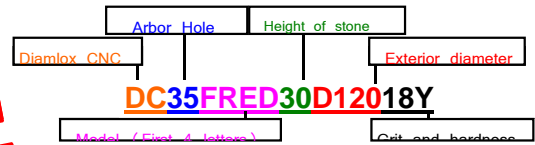

MADE IN CANADA

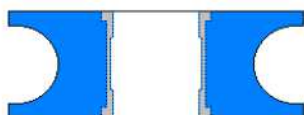
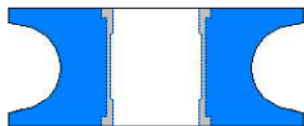
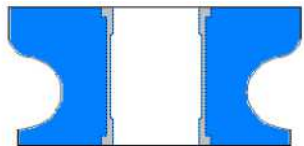
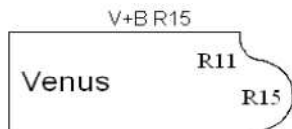
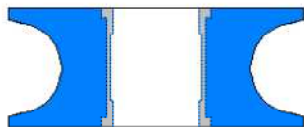
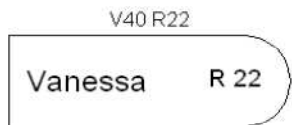
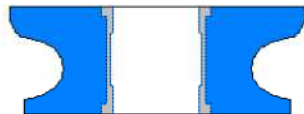
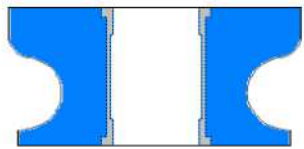
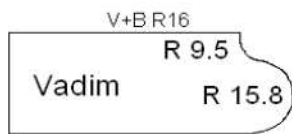
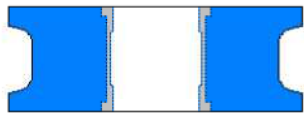
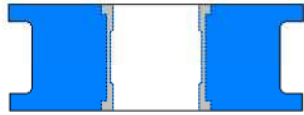
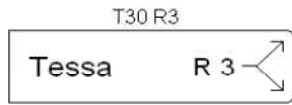

Suggested polishing parameters

Speed : 1 m/min
 R.P.M. : 2500
 Compensation : 0,008 mm/m



CNC Diamlox Polishing tools

Resin bonded diamond products

When you order, please indicate the model and :

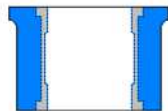
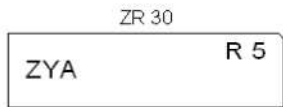
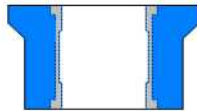
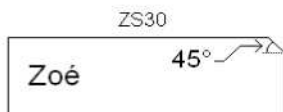
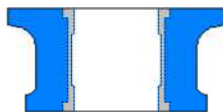
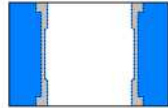
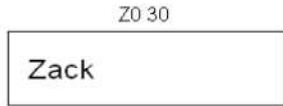

MADE IN CANADA

Diameter
 80mm (3 5/16"), 90mm (3 1/2")
 98,5mm (3 7/8"), 100mm (4")
 120mm (4 3/4"), 125mm (4 15/16")
 (Other diameters available)

For polishing stone of :
 2 cm (3/4"), 3 cm (1 1/4"), 4 cm (1 5/8")

Arbor hole
 22 mm (7/8"), 22,2 mm (7/8")
 35mm (1 3/8"), 45mm (1 3/4")

Code Ordering example :

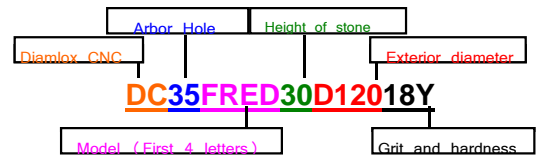

For natural and artificial stone



Suggested polishing parameters
 Speed : 1 m/min
 R.P.M. : 2500
 Compensation : 0,008 mm/m

Other profiles can be made according to your needs.

CNC Diamlox Polishing tools

Resin bonded diamond products

NEW

To be used with our 1/2 gas tool

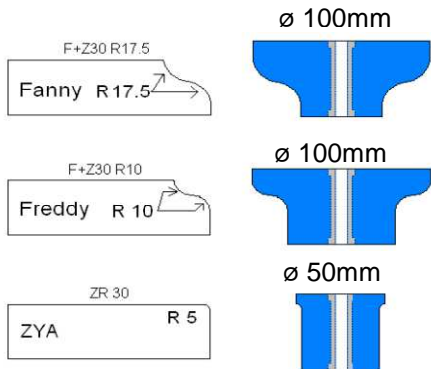

Dismountable part
(reusable tool holder)

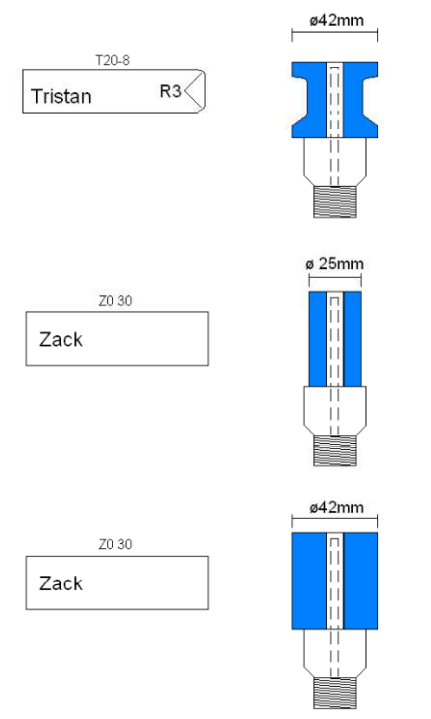

Fixed abrasive
(metal tool holder is not reusable)



Use with
water



**MADE IN
CANADA**

