

# Outils de polissage CNC Diamlox

## Résine Diamantée

Utilisez  
avec  
de l'eau



Lors de votre commande,  
veuillez indiquer le modèle ainsi que :

### Diamètres des pièces :

80mm (3 5/16" ) , 90mm (3 1/2")

98,5mm (3 7/8"), 100mm (4")

120mm (4 3/4"), 125mm (4 15/16")

(Autres diamètres disponibles)

### Pour polissage de pierre de :

2 cm (3/4"), 3 cm (1 1/4"), 4 cm (1 5/8")

### Diamètre central

22 mm (7/8"), 22,2 mm (7/8")

35mm (1 3/8") , 45mm (1 3/4")

**FABRIQUÉ AU  
CANADA**

### Exemple de code de commande

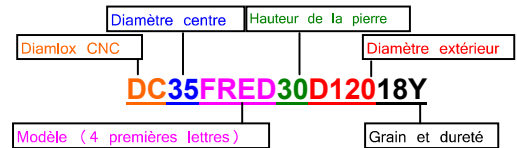

### Paramètres de polissage suggérés

Vitesse d'avance : 1 m/min

R.P.M. : 2500

Compensation : 0,008 mm/m

A30 R15

Adam

R 15

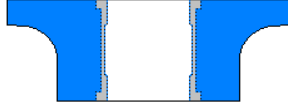

A40 R20

Alan

R 20

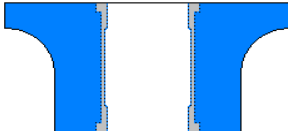

A30 R10

Alex

R 10

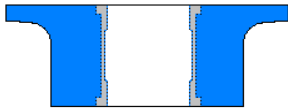

A30 R6.5

Alicia

R 6.5

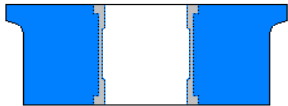

A30-1

André

R 15  
R 3

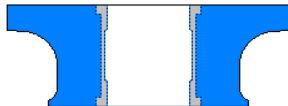

AR30-2

Arthur

°45

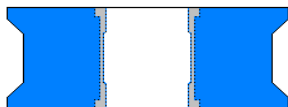

B+B30

Barbara

R 10

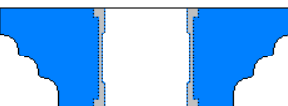

B40 R38

Bart

R 38

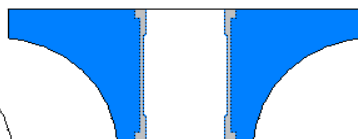

Tél (819) 652-2772

Fax : (819) 652-2773

Email : abressa.maruxa@bellnet.ca

# Outils de polissage CNC Diamlox

7

Utilisez  
avec  
de l'eau



Résine Diamantée

Lors de votre commande,  
veuillez indiquer le modèle ainsi que :

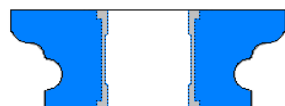
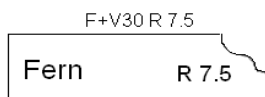
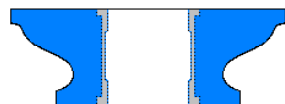
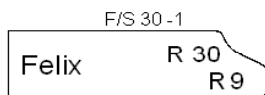
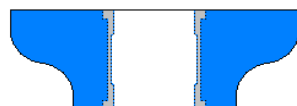
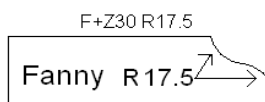
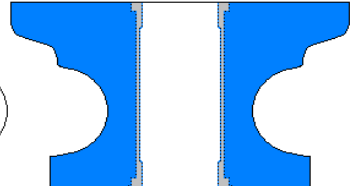
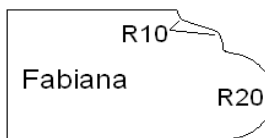
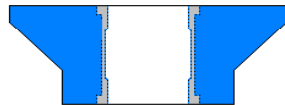
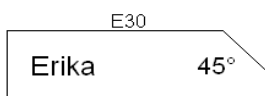
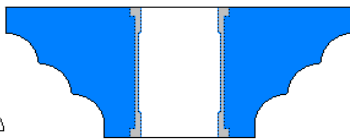
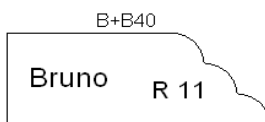
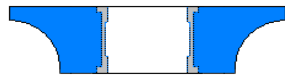
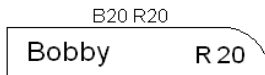
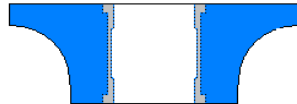
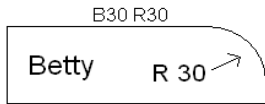

**Diamètres des pièces :**  
**80mm** (3 5/16"), **90mm** (3 1/2")  
**98,5mm** (3 7/8"), **100mm** (4")  
**120mm** (4 3/4"), **125mm** (4 15/16")  
 (Autres diamètres disponibles)

**Pour polissage de pierre de :**  
**2 cm** (3/4"), **3 cm** (1 1/4"), **4 cm** (1 5/8")

**Diamètre central**  
**22 mm** (7/8"), **22,2 mm** (7/8")  
**35mm** (1 3/8"), **45mm** (1 3/4")

**FABRIQUÉ AU  
CANADA**

## Exemple de code de commande

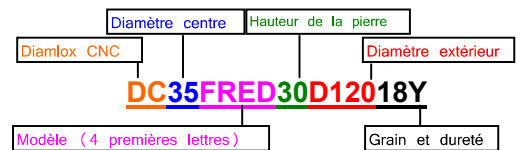

## Paramètres de polissage suggérés

Vitesse d'avance : 1 m/min  
 R.P.M. : 2500  
 Compensation : 0,008 mm/m

Tél (819) 652-2772

Fax : (819) 652-2773

Email : abressa.maruxa@bellnet.ca

# Outils de polissage CNC Diamlox

8

Utilisez  
avec  
de l'eau 

Résine Diamantée

Lors de votre commande,  
veuillez indiquer le modèle ainsi que :

F+Z30 R15  
Fiona R 15

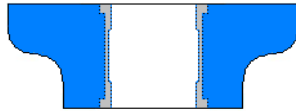

FS/20  
Franck R11  
R5



F+Z30 R10  
Freddy R 10

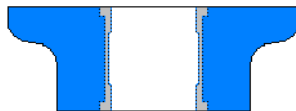

GV20 R18  
Gina R18  
R 6



GV30 R34  
Grace R 34  
R 9

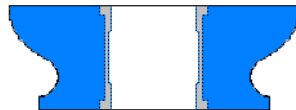

GV30 R38  
Gustav R 38  
R 9.6

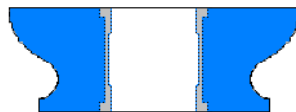

H30 R27  
Hector Dupont S R 27

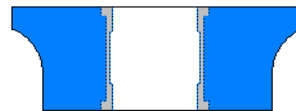

H30 R25  
Helene Dupont L R 25

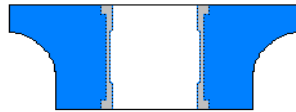

**FABRIQUÉ AU  
CANADA**

**Diamètres des pièces :**  
80mm (3 5/16" ) , 90mm (3 1/2")  
98,5mm (3 7/8"), 100mm (4")  
120mm (4 3/4") , 125mm (4 15/16")  
(Autres diamètres disponibles)

**Pour polissage de pierre de :**  
2 cm (3/4") , 3 cm (1 1/4") , 4 cm (1 5/8")

**Diamètre central**  
22 mm (7/8") , 22,2 mm (7/8")  
35mm (1 3/8") , 45mm (1 3/4")

## Exemple de code de commande

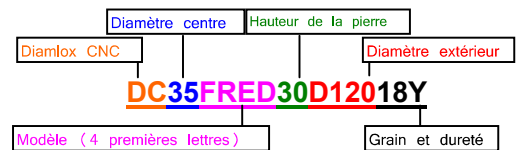

## Paramètres de polissage suggérés

Vitesse d'avance : 1 m/min  
R.P.M. : 2500  
Compensation : 0,008 mm/m

Tél (819) 652-2772

Fax : (819) 652-2773

Email : abressa.maruxa@bellnet.ca



# Outils de polissage CNC Diamlox

## Résine Diamantée

L-2  
Laval R 10

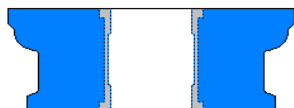

O30  
Odette

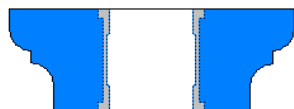

OG30 R10  
Oscar R 10  
R 3

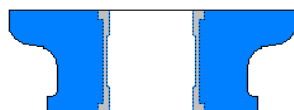

Q30  
Québec R10

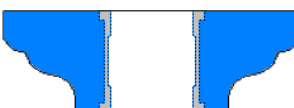

SM30  
Sarah R 30

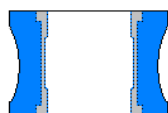

SM20  
Suzie R20

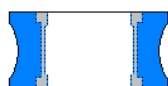

T30 R6  
Talya R 6

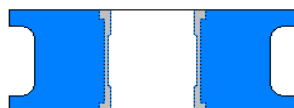

T20 R3.5  
Teddy R 3.5

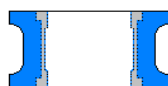

Lors de votre commande,  
veuillez indiquer le modèle ainsi que :

### Diamètres des pièces :

80mm (3 5/16"), 90mm (3 1/2")

98,5mm (3 7/8"), 100mm (4")

120mm (4 3/4"), 125mm (4 15/16")

(Autres diamètres disponibles)

### Pour polissage de pierre de :

2 cm (3/4"), 3 cm (1 1/4"), 4 cm (1 5/8")

### Diamètre central

22 mm (7/8"), 22,2 mm (7/8")

35mm (1 3/8"), 45mm (1 3/4")

**FABRIQUÉ AU  
CANADA**

### Exemple de code de commande

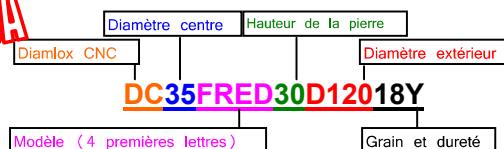

### Paramètres de polissage suggérés

Vitesse d'avance : 1 m/min

R.P.M. : 2500

Compensation : 0,008 mm/m



# Outils de polissage CNC Diamlox

## Résine Diamantée

T30 R3  
Tessa R 3

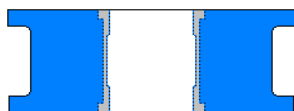

T30 R9.5  
Tim R 9.5

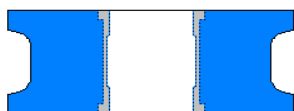

V+BR16  
Vadim R 9.5  
R 15.8

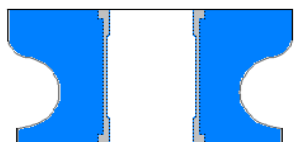

V+BR12  
Val R 8  
R 12

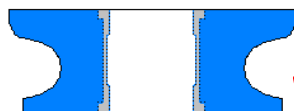

V40 R22  
Vanessa R 22

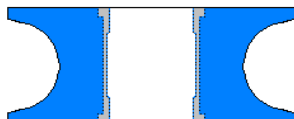

V+BR15  
Venus R11  
R15

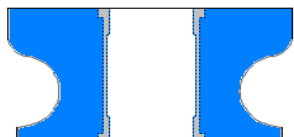

V40 R20  
Vicky R 20

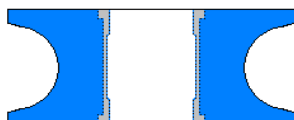

V30 R15  
Victor R 15.8

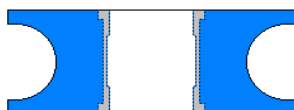

Lors de votre commande, veuillez indiquer le modèle ainsi que :

**Diamètres des pièces :**

80mm (3 5/16"), 90mm (3 1/2")  
98,5mm (3 7/8"), 100mm (4")  
120mm (4 3/4"), 125mm (4 15/16")  
(Autres diamètres disponibles)

**Pour polissage de pierre de :**

2 cm (3/4"), 3 cm (1 1/4"), 4 cm (1 5/8")

**Diamètre central**

22 mm (7/8"), 22,2 mm (7/8")  
35mm (1 3/8"), 45mm (1 3/4")

**FABRIQUÉ AU CANADA**

**Exemple de code de commande**

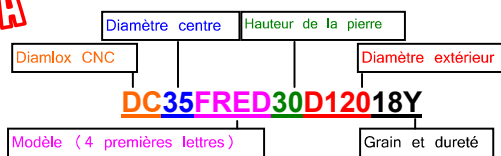

**Pour pierre naturelle et artificielle**

**Paramètres de polissage suggérés**

Vitesse d'avance : 1 m/min  
R.P.M. : 2500  
Compensation : 0,008 mm/m

# Outils de polissage CNC Diamlox

11

## Résine Diamantée

Lors de votre commande, veuillez indiquer le modèle ainsi que :

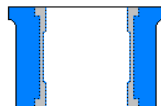
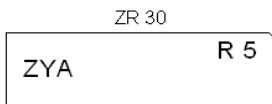
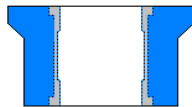
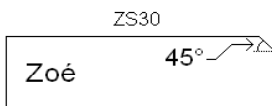
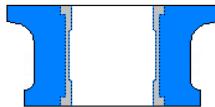
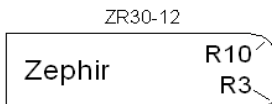
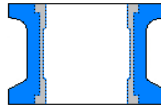
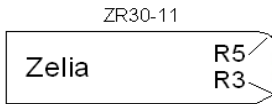
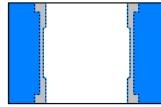
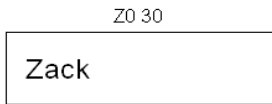

Utilisez avec de l'eau



FABRIQUÉ AU CANADA

Autres modèles disponibles selon vos besoins.

### Diamètres des pièces :

80mm (3 5/16"), 90mm (3 1/2")

98,5mm (3 7/8"), 100mm (4")

120mm (4 3/4"), 125mm (4 15/16")

(Autres diamètres disponibles)

### Pour polissage de pierre de :

2 cm (3/4"), 3 cm (1 1/4"), 4 cm (1 5/8")

### Diamètre central

22 mm (7/8"), 22,2 mm (7/8")

35mm (1 3/8"), 45mm (1 3/4")

### Exemple de code de commande

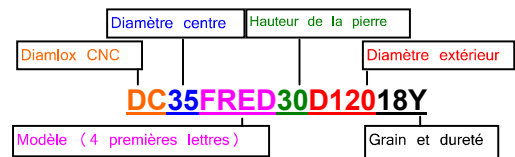

Pour pierre naturelle et artificielle



### Paramètres de polissage suggérés

Vitesse d'avance : 1 m/min

R.P.M. : 2500

Compensation : 0,008 mm/m

# Outils de polissage CNC Diamlox

12

**NOUVEAU**

Résine Diamantée

À utiliser avec nos mandrins 1/2 gas

F+Z30 R17.5  
Fanny R 17.5



F+Z30 R10  
Freddy R 10



ZR 30  
ZYA R 5



**Pièce démontable**  
(mandrin réutilisable)



Utilisez  
avec  
de l'eau

T20-8  
Tristan R3

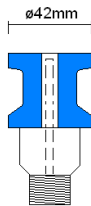

Z0 30  
Zack

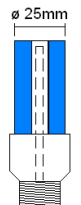

Z0 30  
Zack

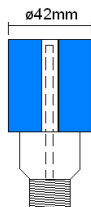

**Pièce fixe**  
(mandrin non-réutilisable)



**FABRIQUÉ AU  
CANADA**